

# Splash!

*"Whoever drinks the water I give them will never thirst."  
John 4:14*

**October 2022**

*Living Water*  
Lutheran Church



PASTOR  
Mark Rossman

PASTOR  
Shari Bernau

OFFICE/COMMUNICATIONS  
MANAGER  
Jennifer Kelsh

FINANCE MANAGER  
Stephanie McLean

CHOIR DIRECTOR  
Marcie Donavon

PRAISE BAND DIRECTOR  
Scott Sims

[www.LWLCAZ.org](http://www.LWLCAZ.org)

## **CONTENTS**

*Prayer List*

*Pastor's Message*

*Ask Zeke*

*Studies & Retreats*

*News & Events*

# Welcome to Worship!

Every Sunday at 10:00am

Living Water Lutheran Church  
9201 E Happy Valley Road  
Scottsdale, AZ 85255

9201 E Happy Valley Road / Scottsdale, AZ 85255

# *We Remember in Our Prayers*

- Mary Ann Bartley—Health Concerns
- Don Benson—Health Concerns
- Barbara Brooks—Health Concerns
- Kristy Burke (Friend of Frances DeBruyn)—Health Concerns
- Christi (Daughter of Charlie and Sue Boyd)—Health Concerns
- Cole (Pat and Janet Guthrie's grandson)
- Larry Coutts—Health Concerns
- Danielle (Friend of Mike and Melissa Freesh)—Health Concerns
- Kristina Decknick (Friend of Michelle Brown)—Battling Covid
- Sue Dixon (Sister of Rick Sherrin)—Health Concerns
- Dominic and Megan (Friends of Deb Bash) Dominic is a Trauma Surgeon with Air Force in Kabul
- Vicki Dugas (Friend of Barbara & John Hannan)—Battling Cancer
- Jenna Fjeld—Health Concerns
- Joe Franch (Friend of Kathie Roenigk)—Health Concerns
- Dave and Joy Gallimore—Health Concerns
- Vicki Grimsley (mother of Mason Rossman)—Cancer
- Barbara Gunderson—Health Concerns
- Tyler Hornacek (Grandson of John & Sue Hornacek)—Deployed
- Michael Koch (Grandson of Ron and Shirley Koch)—Health Concerns
- Lee Landon—Health Concerns
- Katy Lauritsen (Family Member of Steve and Susan Johnson)—Battling Cancer
- Hannah Lehrke (Granddaughter of Jay and Lois Lucas)—Health Concerns
- Marni Lucas (Daughter of Lois Lucas)—House Fire
- Michael (Cousin of Lynda Cales)—Health Concerns
- Richard Reeder Sr. (Friend of Michelle Brown)—Health Concerns
- Bobby Reiser—Health Concerns
- Henry Roenigk—Health Concerns
- Ruth Schlesinger—Health Concerns
- Joan Sprinkle—Health Concerns
- Sumi and Celine (Friends of Diane vanMaanen)—Health Concerns
- Jim and Carolyn Tonneson—Health Concerns
- Gavin Vaughan (Nephew of Gordon & Marty Lindert)—Health Concerns
- Sandy and Dale Williamson (Parents of Heidi Ruff)—Health Concerns
- Charlie (Friend of Daryl & Diane vanMannen)
- People of Ukraine
- Family and Friends of Jim Almgren (Cousin of Carol Jacobson)
- Family and Friends of Richard Wehr

*Send your prayer requests to [prayer@lwlcaz.org](mailto:prayer@lwlcaz.org) or fill one out at [lwlcaz.org](http://lwlcaz.org)*

## *A Message from Pastor Mark*

Much of what was done in the early years of the Christian Church was based on the understanding of the importance of fellowship. The gathering of Jesus and the disciples at the Last Supper was a meal shared and in those early years of Christianity such feasts were commonplace. The whole idea of getting together to spend quality time with other people of the faith was pretty much the center of their lives together. While those beginnings have been transformed into our Sunday morning worship, there is a certain aspect of those early gathering that have remained in our communities of faith. One such thing is our Annual Picnic which is going to be held at the McCormick-Stillman Railroad Park on October 9 from 4:00-7:00 PM

Another quasi-Lutheran type of celebration is the celebration of Oktoberfest. The German Oktoberfest celebration has become closely knit to Lutheranism because of its Bavarian Germanic beginnings. The variety of foods coupled with the opportunity to sit and celebrate life along with the bounty of the harvest is at the center of this ongoing gathering. While our picnic may not hold the same level of food or drink as our overseas brethren's celebration, it is still an event you do not want to miss.

It is the number of people who share in this day that make it so much fun and so very effortless. If just a couple of people were to be responsible for providing that amount of food to everyone, then the task would seem impossible. But rather, we have a good solid group of folks who are willing to share the vast variety of their skills to make for a very delightful afternoon.

That is part of the joy of being in a community. In a community we are able to take tasks that would be daunting and turn them into something easy and in this case, a great deal of fun. In a community we are able to do things that would be impossible for an individual to accomplish, and together are able to make the workload quite light. In a community we are able to care for the needs of one another that would never happen if we were out there on our own.

Community is a central theme of the church and of Living Water. In our community we can accomplish the impossible. In our community we can see things through that we would not be able to handle alone. In our community we can do the ministry of God in a way that would not and could not happen if we tried it alone. In our community, we can celebrate life in a way that simply is not possible to do on our own. With the help of God, in our community we can do anything – anything at all.

As it is with all times of our lives, there will be many unexpected and unanticipated challenges we will be facing in the days and months to come. But when we do gather to take on a task, what we find is that we turn a challenge into a celebration. For in that which we do together as God's people, we celebrate such opportunities that have been set before us. As a community, when we work together, when we each take a piece of the greater task, when we all band together for a common goal, with God's help there is nothing, absolutely nothing we cannot accomplish

*Great Gatherings invites you to our  
Living Water Lutheran Church  
Annual Picnic 2022*

**Please come join us!**

Date: Sunday, **October 9, 2022**  
Time: 4:00- 7:00pm  
Place: McCormick-Stillman Railroad Park. Rotary Pavilion (Far Westside of the Park)  
Address: 7301 E. Indian Bend, Scottsdale, AZ 85250  
Cost: Monetary donations will be welcome at the picnic!

LWLC will provide hamburgers, hotdogs and all the fixings. Please bring your own water, soft drinks and ice. This year we are also asking attendees to bring a potluck dish. Bring your favorite Vegetable, Salad or Dessert.

There will be fun games to play, you can even try your hand at our rendition of Frisbee Golf! The picnic will also provide a perfect opportunity for fellowship outside in the fresh air.

And if you are so inclined, take a ride on the train or visit the various attractions. Check current times on their Website.

If you are interested in model trains, there is a really cool Model Railroad Building which houses a variety of HO trains. Check them out on this Website:  
<https://www.therailroadpark.com/rides-and-attractions/model-railroads/>.

If you arrive early (before 4:00pm), there is a museum that features the Campaign Train of FDR. (\$2 each, children 12 and under are free) Check it out:  
<https://www.therailroadpark.com/rides-and-attractions/trains-cars/>

Please sign up early at our kiosk in the Narthex! We look forward to seeing you and enjoying the fellowship!

If you have questions, please call Marty Lindert at 602-284-5704 or LWLC at 480-473-8400.

**\*Please Mark your Calendars for December 4<sup>th</sup>, 2022. Great Gatherings has reserved this date for our Annual Advent Dinner to be held at McDowell Center in McDowell Mountain Ranch. Watch your Bulletin for more information!**

SCOTTSDALE RD

INDIAN BEND RD

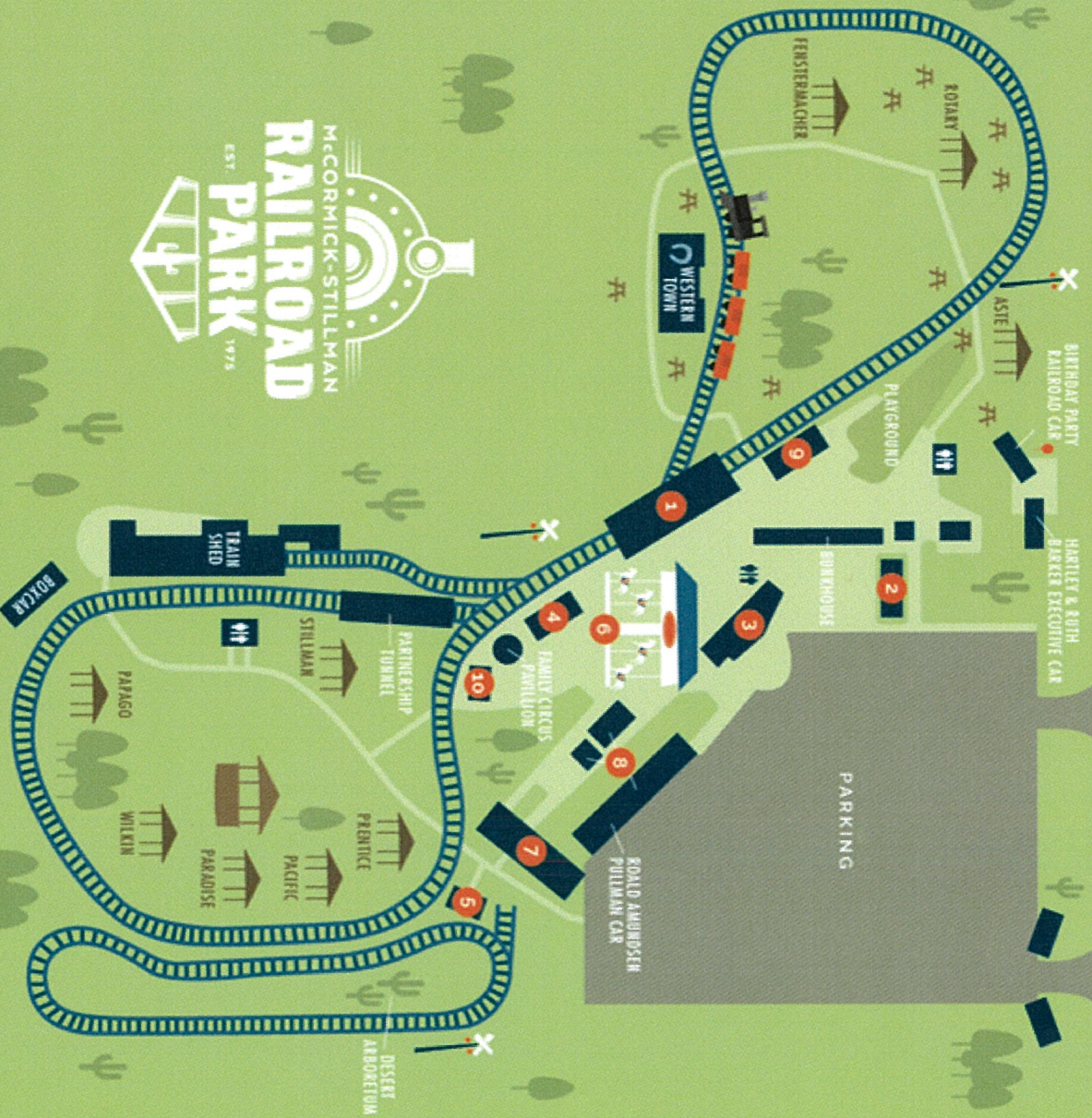

	RESTROOMS
	TRAIN TRACKS
	DROP-IN PICNIC TABLES
	RAMADAS
	1 PARADISE & PACIFIC RAILROAD
	2 FRENCH GRATITUDE BOXCAR
	3 STILLMAN STATION
	4 HARTLEY'S GENERAL STORE
	5 SCOTTSDALE LIVE STREAMERS
	6 CHARROS CAROUSEL
	7 MODEL RAILROAD BUILDING
	8 SCOTTSDALE RAILROAD MUSEUM
	9 SNACK STOP
	10 MARICOPA DEPOT

*Living Water Lutheran Church  
Annual Picnic 2022*

# **The 2022 FUND FOR LEADERS Golf Classic**

Since 2000 the ELCA Fund for Leaders has supported over 1,000 pastors with more than \$25 million in Scholarship Support. Living Water Lutheran Church has supported this fund for many years. We do this by participating in and financially supporting the Annual Golf Classic.

Mark your calendars for Monday, November 14, 2022 for this year's annual Fund for Leaders Golf Classic. The event is in the morning and includes lunch. It will be held at Arrowhead Country Club in Glendale, AZ. More information will be forthcoming.



Lance Jacobson  
480-466-6053  
[jlancejacobson@gmail.com](mailto:jlancejacobson@gmail.com)

# Pet Festival

A free, family-friendly  
community event  
featuring furry friends & more

Blessing of the Animals

Allergic to pets? Bring your stuffed animal.

Scottsdale PD K-9 Demo

Dog Agility Demo

Ben the Clydesdale

Photo Booth & Refreshments

1pm on Sunday, Nov. 13

LIVING WATER LUTHERAN CHURCH

All pets & people are welcome.

Pets MUST be leashed or otherwise secured.

Sponsored by PACE (Pro-Active Community Engagement team)

A Celebration of Life Ceremony  
*for*

**Richard Wehr**

will be held on  
Saturday, October 15th  
at 11:00am  
at Living Water



reception and light lunch to follow





# Ask Zeke



*Living Water's 24/7 office fish*

*Living Water's 24/7 office fish puts in a plug for a positively purr-fect pet-centric event for you, your pets, and your pals*

**Q. I heard a Pet Festival is on the horizon. Will it include a K-9 demo?**

**A.** The riveting demonstration of a police dog taking down a “perp” – an officer in a bite-suit – a few years ago was certainly a crowd-pleaser. Unless the Scottsdale PD K-9 unit gets a last-minute call to tackle an actual perp, you'll have another opportunity to watch this spellbinding demo.

This year's Pet Festival is scheduled for 1:00 pm on Sunday, Nov. 13. In addition to the K-9 demo, this fun-filled afternoon event will feature a spectacular Dog Agility Demo and an extremely tall VIP: Ben the Clydesdale.

Another highlight will be the Blessing of the Animals. Does your pet need a booster blessing? Or maybe you have a new pet. Are your kiddos allergic to pets but have a favorite stuffed animal? Two pastors will be on hand to bless creatures great and small. A photo booth will also be available for taking selfies with your precious pet.

Folks who participated in Living Waster's first two Pet Festival may recall that dogs dominated the pet turnout (they all got along famously). The first festival also attracted a pair of guinea pigs, a hamster, a cat, and a slightly scary snake (one of the pastors bravely blessed it).

This free, family-friendly festival is sponsored by PACE (Living Water's Pro-Active Community Engagement team). PACE encourages everyone to invite family members, friends, neighbors, and classmates to this joyful celebration of God's critters. Please note that ALL pets, no matter how tame or tiny, MUST be leashed or otherwise secured.

Not a pet owner? No problem! You can rove without Rover at this celebration of four-legged friends and other pets. Of course, you *could* borrow a pal's pet that day. Or, you still have a few weeks to visit an animal rescue center and adopt a new fur-ever friend. Meow? Ruff? Squeak? Chirp? Neigh?

*Do you have a question for Zeke? E-mail it to him at [AskZeke@cox.net](mailto:AskZeke@cox.net) or contact his writing partner, Jill Wehr, at 480-515-4813.*

# Men's Bible Breakfast

Thursdays at **8:30AM**

**Spirit in the Desert Retreat Center**

**7415 East Elbow Bend Rd.**

**Carefree, AZ 85377**

Carpool leaves church @ 8:15AM

\$7 for breakfast



Sing to the Lord a new song! The Living Water Choir welcomes new and returning singers, and now is the perfect time to join. We are just kicking off the program year, and we invite YOU to come and sing with us! Rehearsals are Wednesdays at 7 pm in the Psalms room of the Christian Education building. All are welcome!



For more information, contact Marcie: 602.321.2561 or email [MLC123@cox.net](mailto:MLC123@cox.net).

## TUESDAY WOMEN'S STUDY



All women are invited to join us, in-person in the Fellowship Hall, or virtually via a Zoom connection, for our Tuesday Women's Bible study time.

We began with new material from women's Bible study author, Melissa Spoelstra, in September. This study centers on Isaiah, a prophet who served as God's mouthpiece to the people of God and the surrounding nations. Isaiah's message reverberates through our lives today as we read his call to rely on the Lord, to strive less and trust God more.

This is a seven-session video-based study will take us through October, and each session will include a video presentation of 20-25 minutes. Purchase of the

accompanying Study Guide is optional but not required. You can purchase the study guide thru Amazon or from Lifeway.com. We meet for 90 minutes every Tuesday morning. Bring your favorite Bible translation. Coffee and hot water for tea/hot chocolate will be available if you're joining us in person. If you aren't on our email notification list for our Tuesday Women, please contact Myrna at [myrna.ulland@gmail.com](mailto:myrna.ulland@gmail.com) to be added to the list.



## La Sagrada Familia Lutheran Food Shelf Needs Our Help!



Your support of non-perishable food items for our neighbors at La Sagrada Familia in northern Phoenix is appreciated, and there is a continuing need. Items needed most frequently are noted on the “shopping list” in the grocery cart that is set out each Sunday morning. For the safety of our

friends at La Sagrada, please do not donate expired or “close-to” date items. Please continue to be generous in remembering our neighbors in need.

---

Sing to the Lord a new song! The Living Water Choir is getting underway for the 2022-2023 program year. YOU are invited to come and sing with us! Rehearsals are Wednesdays at 7 pm in the Psalms room of the Christian Education building. All are welcome!

For more information, contact Marcie: 602.321.2561 or email [MLC123@cox.net](mailto:MLC123@cox.net).





# Family Sunday School

Sunday October 9 at 9:00am

&

Sunday October 23 at 9:00am

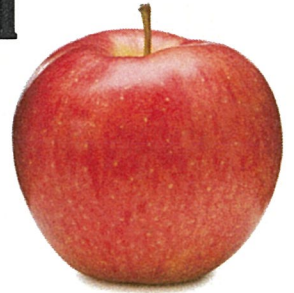

---

## Piecemakers Quilters



Want to help us tie quilts destined for Lutheran World Relief ministries? Join us on the first and third Wednesdays of the month, at 9 am in the Education Building. If you can hold a needle, we can teach you to tie!

Last year, we made more than 100 quilts and we've already resumed this fall.

We will gather next on October 5 and October 19, from 9 am to about noon. We now convene in the Education Building in Matthew/Mark. Many hands make light work! Questions? Ask Lynda Cales, Kay Bonar, Mary Nyberg, Cindy Ophaug or Myrna Ulland. You can also learn more about this ministry at [www.lwr.org/quilts-and-kits](http://www.lwr.org/quilts-and-kits)



# Eastern Europe Crisis Response

## **The Situation:**

On Feb. 24, Russian forces invaded Ukraine, launching land, sea and air attacks. Russia has launched air strikes across the country, including on the capital of Kyiv and other major cities. Millions of people fleeing the violence of Russia's war against Ukraine and are moving toward Ukraine's western districts and such neighboring countries as Poland, Moldova, Slovakia, Romania and Hungary. There are major humanitarian concerns for both internally displaced people and refugees. Many of these Ukrainians fleeing their homes need shelter and such basic necessities as food, water and toiletries. Care for people also includes pastoral and psychological support to address the trauma they've endured.

## **Our Response:**

Lutheran Disaster Response is accompanying our companions in Ukraine, Hungary, Poland, Romania and Slovakia, as well as such ecumenical partners as this Lutheran World Federation and Church World Service, in their humanitarian responses to the crisis created by Russia's war against Ukraine. These partners provide refugees with immediate support and supplies such as food, blankets, water and hygiene kits. Presiding Bishop Elizabeth Eaton has joined other religious leaders from Europe and around the globe in issuing an [interfaith call for peace](#) in the region.

## **What you can do:**

### **Pray:**

Please pray for those in Ukraine, Russia and neighboring countries that have been affected by the war in Ukraine. May God's healing presence give them peace and hope in their time of need.

### **Give:**

Your gifts designated for "[Eastern Europe Crisis Response](#)" will be used entirely (100%) to provide support for people impacted by conflict in the region. To donate online, go to <https://community.elca.org/eastern-europe-crisis-response>

## **AZ TAX CREDITS**

Arizona permits taxpayers to claim multiple credits for contributions to charitable organizations and schools. This means that you can claim credits for donations to Habitat for Humanity (a charitable organization), and to a public school and to ACSTO (a private school tuition organization). For more information, visit <https://azdor.gov/tax-credits>.

### **HABITAT FOR HUMANITY**

Preparations are now underway to build another Habitat home with Lutheran churches starting in 2022 in the Greater Phoenix area. We need to raise our fair share to pay for the out-of-pocket costs that Habitat incurs to build these homes. Our goal is to raise \$4000.

AZ law provides a tax credit for contributions made to qualifying charitable organizations. Habitat is one of the qualifying organizations. So, if you are going to be paying income taxes to the State of Arizona, you can claim a credit on your income tax return. Taxpayers filing as "single" and "head of household" and "married filing separate" may claim a maximum credit of \$400. Taxpayers that file as "married filing joint" may claim a maximum credit of \$800. You may do this even if you don't itemize deductions.

You can either send your check directly to Habitat of Central AZ or hand your check to Greysen West, Financial Manager or to Marilyn or John Goesling. If you send your check directly, please note on your check that it applies to the North-east Lutheran Coalition-Living Water Church. If you need additional information, contact Marilyn or John Goesling. And, if you are interested in working on the build next spring, a signup sheet will be available in the narthex once details are confirmed.

### **Navajo Evangelical Lutheran Mission Christian School**

Here is another AZ Tax credit opportunity. This is through the Arizona Christian School Tuition Organization (ACSTO). One of the schools helped by this tax credit is the Navajo Evangelical Lutheran Mission Christian school in Rock Point. This school needs financial help. We currently help the school with the collection of box top labels. We have found this brings in very little income for the school. This would be more helpful to the school. With this one, you donate right to ACSTO and specifically designate the Navajo Evangelical Lutheran Mission Christian school. Donors can give up to \$1221/\$611 (married/single) towards the original tax credit. Any donation above this amount will then go towards the Overflow Tax Credit, up to a maximum of an additional \$1214/\$608. It is clearly explained at the ACSTO website which is <http://acsto.org>. They walk you through the donation process right there on the website. The website also provides the tax reporting instructions and documents needed if you participate in this unique tax credit opportunity. Also, note that donations can be made in early 2022 if it is before the April tax deadline.



# October Birthdays



Lee	Landon	1-Oct
Nicholas	Ingwersen	1-Oct
Davis	Shelmire	3-Oct
Lily	Shelmire	3-Oct
James	King	3-Oct
Marcia	Page	4-Oct
Michelle	Ruha	4-Oct
Julie Ann	Walker	4-Oct
Jeanne	Donars	8-Oct
Larry	Coutts	9-Oct
Joy	Gallimore	9-Oct
Kip	Wachter	9-Oct

Donna	Pettengill	10-Oct
Julie	Anderson	11-Oct
Mason	Rossman	11-Oct
Barb	Bremer	12-Oct
Ronald	Ophaug	12-Oct
Lisa	Sleeper	14-Oct
Nathan	Fjeld	15-Oct
Kaden	Roos	15-Oct
Zoey	Crow	16-Oct
Barbara	Brooks	16-Oct
Maxine	Crane	17-Oct
Marty	Lindert	17-Oct
Claudia	Igras	18-Oct

Gordon	Lindert	18-Oct
Aubrey	Coutts-Donavon	19-Oct
Lynda	Cadden	23-Oct
Darnell	Pettengill	24-Oct
Mike	Sadler	24-Oct
Kristin	Smith	25-Oct
Matt	Wanek	26-Oct
Michael	Alberti	28-Oct
Sharon	Augenstein	28-Oct
Miriam	Bernau	30-Oct
Tim	Mouer	31-Oct
Jaida	Sleeper	31-Oct



Please call the office if your birthday is not listed and we will make sure to enter it into our database.

**Publication Deadlines:**  
Connections- Every Tuesday by noon  
SPLASH! - The 20th of each month by noon

